

STONE WALL-HUNG BIDET STS11BI

CE EN 14528:2015



Ceramic antibacterial effect
BATAFORM®



Bagno di Colore



Glazed product with
CERASLIDE®

Cod. **STS11BI**

Wall-hung Bidet 45.37 h33 cm. Fixing kit included. Weight 16 Kg

GLOBO

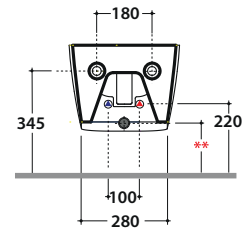
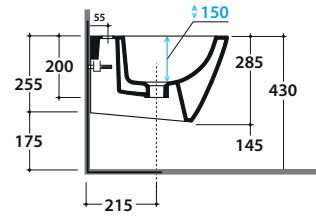
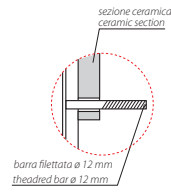
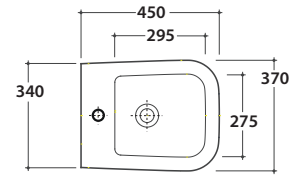

** For installation with:
Siphon "S"-140 mm
Siphon SF052- 120 mm



Cod. **FI012BI**

Push open valve drain with ceramic top for bidet. Weight 0,5 Kg



Cod. **FI012CR**

Push open chromed valve drain for bidet. Weight 0,5 Kg



Cod. **PU001**

Acoustic and crash protection.



Cod. **F1002**

Fixing brackets for W/H sanitary. Weight 2,5 Kg